

BEARING UNITS

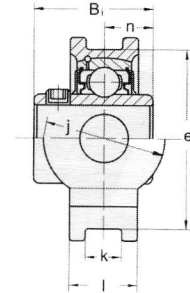

TAKE-UP UNITS UCT 200 Series Normal Duty Set Screw Locking Narrow Slot

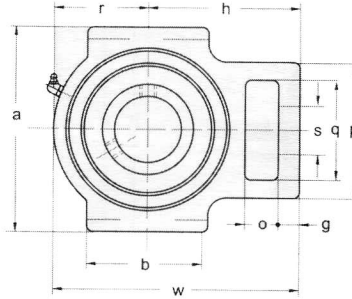
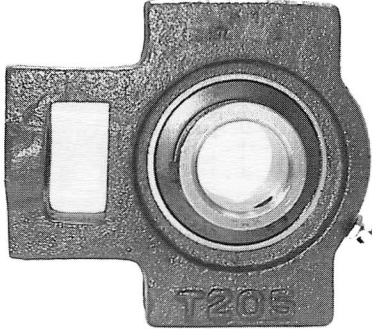

BEARING
UNITS

Unit No.	Shaft Dia.		Dimensions inch / mm															Bearing No.	Housing No.	Weight Lbs kg	
	In.	mm	o	g	p	q	s	b	k	e	a	w	l	j	r	h	Bi				n
UCT 201-8	1/2																		UC 201-8		
202-10	5/8	20	5/8	13/32	2	1-1/4	3/4	2	15/32	3	3-1/2	3-11/16	13/16	1-1/4	1-19/64	2-13/32	1.220	0.500	UC 202-10	T 204	1.69
204																			204		0.77
204-12	3/4																		204-12		
UCT 205		25																	UC 205		
205-14	7/8		5/8	13/32	2	1-1/4	3/4	2	15/32	3	3-1/2	3-13/16	15/16	1-1/4	1-3/8	2-7/16	1.339	0.563	UC 205-14	T 205	1.89
205-15	15/16																		205-15		0.86
205-16	1																		205-16		
UCT 206		30																	UC 206		
206-17	1-1/16		5/8	13/32	2-7/32	1-29/64	7/8	2-1/4	15/32	3-1/2	4-1/64	4-7/16	1-3/32	1-29/64	1-11/16	2-3/4	1.500	0.626	UC 206-17	T 206	2.90
206-18	1-1/8																		206-18		1.32
206-19	1-3/8																		206-19		
206-20	1-1/4S																		206-20		
UCT 207		35																	UC 207		
207-20	1-1/4		5/8	1/2	2-33/64	1-29/64	7/8	2-33/64	15/32	3-1/2	4-1/64	5-5/64	1-3/16	1-29/64	2	3-5/64	1.689	0.689	UC 207-20	T 207	3.50
207-21	1-5/16																		207-21		1.59
207-22	1-3/8																		207-22		
207-23	1-7/16																		207-23		
UCT 208		40																	UC 208		
208-24	1-1/2		3/4	5/8	3-9/32	1-59/64	1-3/16	3-9/32	5/8	4-1/64	4-1/2	5-11/16	1-19/64	1-59/64	2-7/32	3-15/32	1.937	0.748	UC 208-24	T 208	5.06
208-25	1-9/16																		208-25		2.30
UCT 209		45																	UC 209		
209-26	1-5/8		3/4	5/8	3-9/32	1-59/64	1-3/16	3-9/32	5/8	4-1/64	4-19/32	5-23/32	1-3/8	1-59/64	2-1/4	3-15/32	1.937	0.748	UC 209-26	T 209	5.50
209-27	1-11/16																		209-27		2.50
209-28	1-3/4																		209-28		
UCT 210		50																	UC 210		
210-30	1-7/8		3/4	5/8	3-9/32	1-59/64	1-3/16	3-25/64	5/8	4-1/64	4-19/32	5-15/16	1-29/64	1-59/64	2-21/64	3-5/8	2.031	0.748	UC 210-30	T 210	5.72
210-31	1-15/16																		210-31		2.60
210-32	2S																		210-32		
UCT 211		55																	UC 211		
211-32	2		31/32	3/4	4-1/64	2-33/64	1-3/8	3-3/4	7/8	5-1/8	5-3/4	6-23/32	1-1/2	2-33/64	2-9/16	4-11/64	2.187	0.874	UC 211-32	T 211	9.02
211-34	2-1/8																		211-34		4.10
211-35	2-3/16																		211-35		
UCT 212		60																	UC 212		
212-36	2-1/4		1-1/4	3/4	4-1/64	2-33/64	1-3/8	4-1/64	7/8	5-1/8	5-3/4	7-5/8	1-21/32	2-33/64	2-61/64	4-11/16	2.563	1.000	UC 212-36	T 212	10.56
212-38	2-3/8																		212-38		4.80
212-39	2-7/16																		212-39		
UCT 213		65																	UC 213		
213-40	2-1/2		1-1/4	13/16	4-3/8	2-3/4	1-5/8	4-49/64	1-1/32	5-15/16	6-9/16	8-13/16	1-3/4	2-3/4	3-7/16	5-25/64	2.563	1.000	UC 213-40	T 213	14.96
																			213-40		6.80
UCT 214		70																	UC 214		
214-43	2-11/16		1-1/4	13/16	4-3/8	2-3/4	1-5/8	4-49/64	1-1/32	5-15/16	6-9/16	8-13/16	1-13/16	2-3/4	3-7/16	5-25/64	2.937	1.189	UC 214-43	T 214	15.40
214-44	2-3/4																		214-44		7.00
UCT 215		75																	UC 215		
215-47	2-15/16		1-1/4	13/16	4-3/8	2-3/4	1-5/8	4-49/64	1-1/32	5-15/16	6-9/16	8-1/8	1-13/16	2-3/4	3-5/8	5-1/2	3.063	1.311	UC 215-47	T 215	17.16
215-48	3																		215-48		7.80